

IEC appliance inlet C14, screw-on mounting, front/rear side, solder/quick connect terminal



6100-3

C14



70° C

**Description**

- Panel Mount:  
Screw-on from front or rear-side
- Appliance inlet, Pin temperature 70 °C, Protection class I
- Solder terminals or quick connect terminals
- Alternative: protection class II version 6102-3

**Approvals**

- VDE License Number: 40015595
- UL License Number: E96454
- CSA License Number: 38456

**Other versions on request**

- Types for rivet mounting available upon request
- Types for enhanced glow wire test requirements acc. IEC 60695-2-11 to -13 for the use in unattended household equipment acc. IEC 60335-1

**Weblinks**

[Approvals](#), [RoHS](#), [CHINA-RoHS](#), [e-Store](#), [SCHURTER-Stock-Check](#), [Distributor-Stock-Check](#)

**Technical Data**

Ratings IEC	10 A / 250 VAC; 50 Hz
Ratings UL/CSA	15 A / 250 VAC; 60 Hz
Dielectric Strength	> 2 kVAC between L-N > 2 kVAC between L/N-PE (1 min/50 Hz)
Allowable Operation Temp.	-25 °C to 70 °C
Degree of Protection	from front side IP 40 acc. to IEC 60529
Protection Class	Suitable for appliances with protection class I acc. to IEC 61140
Terminal	Solder terminals or quick connect terminals
Panel Thickness s	Screw-on: max 8 mm Mounting screw torque max 0.5 Nm
Material: Housing	Thermoplastic, black, UL 94V-0

Appliance-Inlet/-Outlet	C14 acc. to IEC/EN 60320-1, UL 498, CSA C22.2 no. 42 (for cold conditions) pin-temperature 70 °C, 10 A, Protection class I
-------------------------	---

**Dimensions**

6100-3 (6102-3)

Length |-----| 48 mm

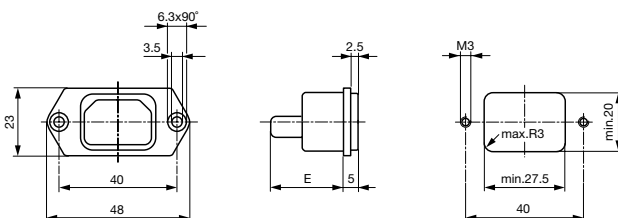

E: Solder terminals 20.5 mm

E: Quick connect terminals 23.5 mm

**Variants**
[Distributor-Stock-Check](#) | [SCHURTER-Stock-Check](#) | [e-Store](#)

Type	Protection Class	Panel mounting	Panel Thickness s [mm]	Terminal	Order Number
6100-3	I	Screw-on	-	Quick connect terminals 4.8 x 0.8 mm	6100.3200
6100-3	I	Screw-on	-	Quick connect terminals 6.3 x 0.8 mm	6100.3300
6100-3	I	Screw-on	-	Solder terminals 3.5 x 0.8 mm	6100.3100

Articles for enhanced glow wire test requirements acc. IEC 60695-2-11 to -13 can be ordered with ending ".15" (xxxx.xxxx.15). They are suitable for the use in unattended household equipment acc. IEC 60335-1.

**Packaging unit** 50 Pcs

## Accessory

### Description



**Assorted Covers**  
Rear Cover

	0859.0048
	4311.9401
	4311.9402
	4311.9404



**Cord retaining kits**  
Cord retaining strain relieve

Flat head, A	4700.0001
--------------	-----------

## Mating Outlet/Connector

### Category / Description



Appliance Inlet

IEC cord connector C15, rewirable, angled	0169
---	------

Appliance Outlet



IEC cord connector C15, rewirable, straight	0101
IEC cord connector C15A, rewirable, straight	0102
IEC cord connector C15A, rewirable, straight	0102-G
IEC cord connector C15A, rewirable, angled	0112
IEC cord connector C13, rewirable, angled	4012
IEC cord connector C13, rewirable, angled	4013
IEC cord connector C13, rewirable, straight	4020
IEC cord connector C13, rewirable, straight	4021
IEC cord connector C13, rewirable, straight	4022
IEC cord connector C13, rewirable, angled	4300-06

**Power Entry Module**



Power Cord with IEC Appliance Connector C13, angled, 70°C	0311
Power Cord with IEC Appliance Connector C13, angled, 70°C	3011
Power Cord with IEC Appliance Connector C13, angled, 70°C	3012
Power Cord with IEC Appliance Connector C13, angled, 70°C	3013
Power Cord with IEC Appliance Connector C13, 70°C	3020
Power Cord with IEC Appliance Connector C13, straight, 70°C	3027
Power Cord with IEC Appliance Connector C13, straight, 70°C	302U
Power Cord with IEC Appliance Connector C13, straight, 70°C	3030
Power Cord with IEC Appliance Connector C13, angled, 70°C	311L
Power Cord with IEC Appliance Connector C13, angled, 70°C	312L

## Category / Description



xxx

IEC appliance outlet F oder H, screw-on mounting, front side, solder/PCB/quick connect terminal

5091

IEC appliance outlet F oder H, screw-on mounting, front side, solder/quick connect terminal

5092